

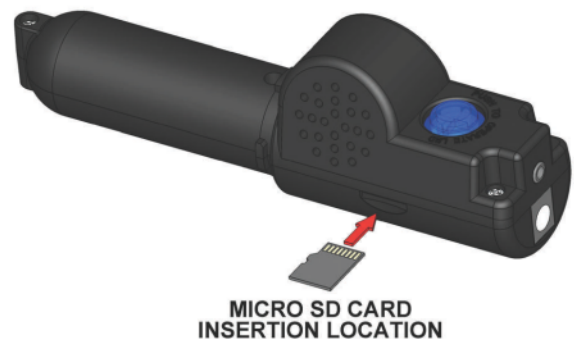

## OPERATING INSTRUCTIONS

**Thank you for purchasing the new AquaTunes product. This product will provide added enjoyment to the wonder of the tropical fish keeping hobby. Please follow the below operating instructions.**

1. After you have installed the AquaTunes unit into the hood place it on top of the aquarium tank and take the small round plug at the end of the cord attached to the 12 volt low voltage transformer and plug it into the rear of the AquaTunes unit Power Receptacle port as shown in the illustration below.
2. Form a drip loop in the cord as shown in the aquarium setup instruction sheet illustration then plug the 12 volt transformer into a standard 120 volt household grounded outlet.
3. You are now ready to operate the AquaTunes unit. The blue button "A" operates the LED light functions, there are many different lighting options with this unit from solid color lights to fading on and off multi-colored lighting.
4. Button "C" turns on/off the AquaTunes sound feature, a momentary push of this button will either turn on or off the sound system.
5. Momentarily pushing button "B" moves the play list back as it is listed on the SD Chip playlist. Holding down this button reduces the sound volume also.
6. Momentarily pushing button "D" moves the play list forward as it is listed on the SD Chip playlist. Holding down this button increases the volume.
7. The AquaTunes unit will scroll through all files that are loaded onto the SD Chip. To continuously repeat one track while the track is playing you want to repeat, press and hold down the blue button "A" for 15 seconds until you will hear a slight interruption in the sound track which indicates the repeat function is activated. To turn off the repeat function you must turn off the sound system using button "C".
8. You can remove the SD Chip by pushing it in gently and releasing and the Chip will pop out enough to grasp it. Be sure to reinstall the Chip in the same orientation as you remove it, pushing it in with light pressure until it clicks into place, When fully engaged the Chip will only be slight protruding outside the AquaTunes housing.
9. You can use the included SD/USB adapter to load additional MP3 file format music files onto the SD Chip. The Chip provided with the unit has preloaded nature sounds provided for your added enjoyment. Only MP3 file formats can be played on the AquaTunes unit, any MP4 formatted files will have to be converted to MP3 format to allow them to play on AquaTunes.
10. The RCA Jack/MP3 Player port allows you to connect any MP3 player to the AquaTunes unit. To operate a stand alone MP3 player connected to this port the AquaTunes power transformer must be used to provide power to the AquaTunes unit. The patch cord needed for this connection is not provided.

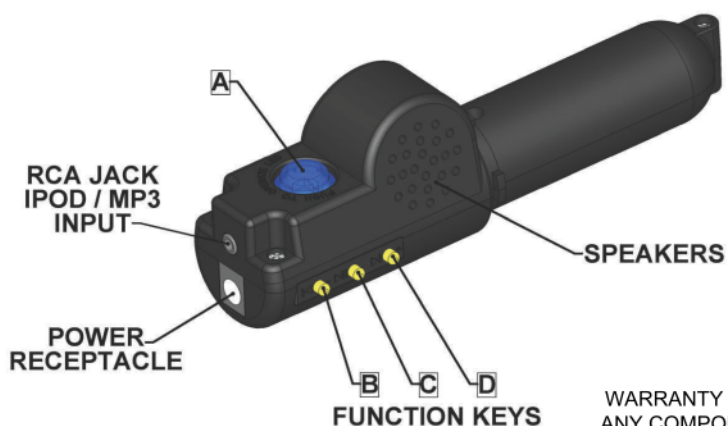

WARRANTY HELP REPLACEMENT PARTS OR TECH SUPPORT IF ANY COMPONENTS ARE DAMAGED OR MISSING DO NOT RETURN TO RETAILER

PLEASE CONTACT:  
customerservice@sunnywaycn.com

SUNNYWAY ENTERPRISES INC  
Tustin, CA 92782



# SW CRAFT LIMITED WARRANTY

KOLLERCRAFT a Division of Koller Enterprises, Inc. warrants this aquarium product to be free from defects in material and workmanship under normal use and service and according to the provisions as specified in the accompanying assembly and operating instructions, for a period of 90 days from date of purchase.

This warranty does not cover and KOLLERCRAFT is not liable for the cost of repair or replacement of parts which have been subject to misuse, negligence, accident, improper installation, damage during shipment or handling, normal deterioration due to wear and exposure or defects caused by unauthorized parts or modification.

**UNDER NO CIRCUMSTANCES WILL KOLLERCRAFT BE LIABLE FOR ACCIDENTAL OR CONSEQUENTIAL DAMAGES, INCLUDING BUT NOT LIMITED TO LOSS OF PROPERTY OR EQUIPMENT**

Some states do not allow the exclusion or limitation of incidental or consequential damages, or limitation on how long an implied warranty lasts, so the above limitations or exclusions may not apply to you. This warranty gives you the legal rights, which vary from state to state.

## **Procedure for Warranty Repairs or Replacement**

If warranty service is necessary, the original purchaser must send the part postage paid with the description of the defect, proof of purchase, to the following address:

WARRANTY HELP REPLACEMENT PARTS OR TECH SUPPORT IF  
ANY COMPONENTS ARE DAMAGED OR MISSING DO NOT RETURN  
TO RETAILER

PLEASE CONTACT:  
customerservice@sunnywaycn.com

SUNNYWAY ENTERPRISES INC  
Tustin, CA 92782